

PRODUCT DATASHEET

SPOT MULTI 1 x 30W 3000K FL WT/BK

SPOT MULTI 1x30W | Recessed mounted spotlight, swivelable with one spot



AREAS OF APPLICATION

- Accent- and general lighting for all kind of salesrooms
- Fashion shops, accessories shops
- Shops, boutiques
- Hotel rooms
- Cafés

PRODUCT BENEFITS

- Low flicker light thanks to special electronic control gear
- High luminous efficacy
- Covering against other ceiling installations thanks to closed sheet steel housing
- Easy replacement of external driver thanks to plug with bayonet lock
- Functional and minimalistic design
- 5 years guarantee

PRODUCT FEATURES

- Large faceted reflector for high light output
- Beam angle: 38°
- Gimbal adjustment angle: +/- 25°



TECHNICAL DATA
Electrical data

Nominal wattage	30.00 W
Operating mode	External LED driver
Nominal voltage	220...240 V
Power factor λ	≥ 0.90
Mains frequency	50/60 Hz
Max. no. of lum. on circuit break. B16 A	32
Max. no. of lum. on circuit break. C10 A	26
Max. no. of lum. on circuit break. C16 A	41
Inrush current	23.0 A
Total harmonic distortion	< 15 %
Inrush current time T_{h50}	<3.4 μ s

Luminaire control gear data

Low flicker	Yes
ECG - Length	113 mm
ECG - Width	40 mm

Photometrical data

Color temperature	3000 K
Luminous flux	2700 lm
Luminous efficacy	90 lm/W
Standard deviation of color matching	≤ 4 sdc _m
Light color (designation)	Warm White
Color rendering index Ra	>80

Light technical data

Beam angle	38.00 °
-------------------	---------

Dimensions & weight

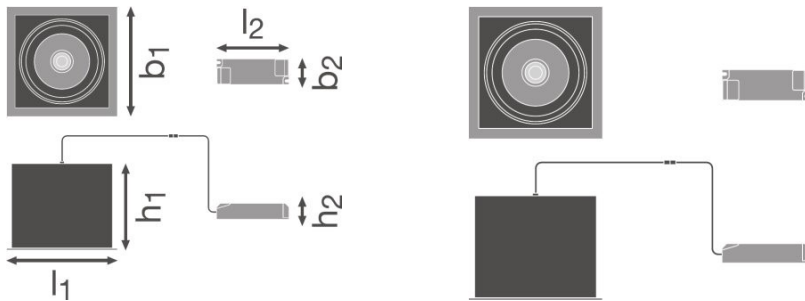

Length	173.0 mm
Width	173.0 mm
Height	135.0 mm
Product weight	1540.00 g

Colors & materials

Body material	Aluminum
Product color	White
Housing color	White
Cover material	Polymethylmethacrylate (PMMA)

Temperatures & operating conditions

Ambient temperature range	-10...+40 °C
----------------------------------	--------------

Lifespan

Number of switching cycles	50000
Lifespan L70/B50 at 25 °C	50000 h
Lifespan L80/B10 at 25 °C	45000 h
Lifespan L90/B10 at 25 °C	30000 h

Additional product data

Mounting type	Recessed
Mounting location	Ceiling
Low flicker	Yes

Capabilities

Adjustable	Yes
Dimmable	No
Type of connection	Screw terminal, 2-Pole (L,N)

LED module replaceable	Not replaceable
-------------------------------	-----------------

Certificates & standards

Protection class IK (shock resistance)	IK03
Glow Wire Test according to IEC 60695-2-12	650 °C
Photobiological safety group EN62778	RG 1
Protection class	II
Type of protection	IP20
Standards	CE/CB/ENEC/TÜV SÜD/RoHS

Light Distribution

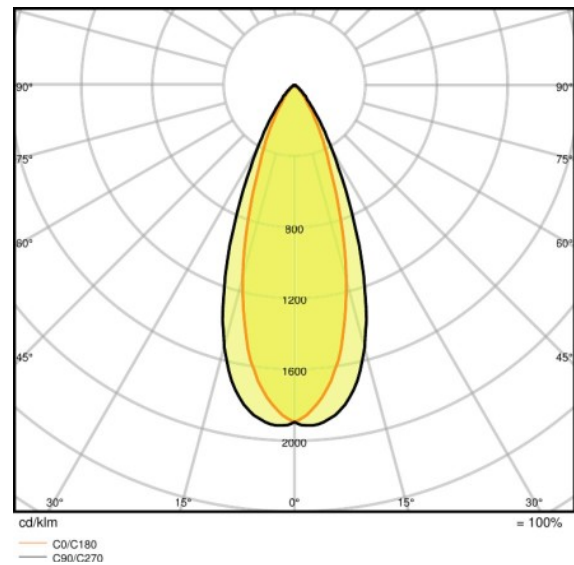
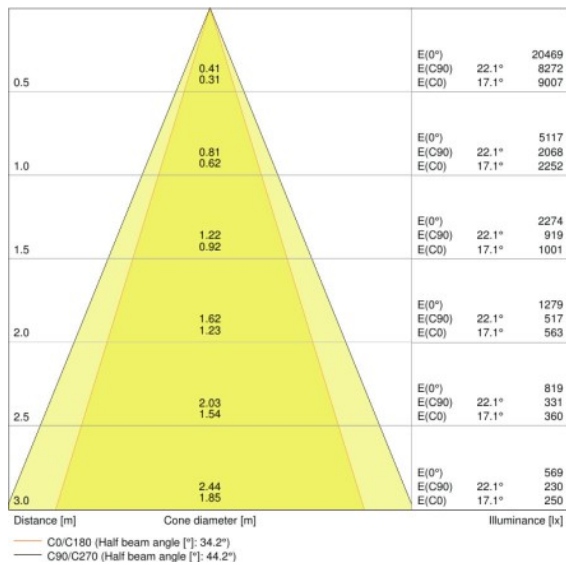

LDC typ cone

LDC typ polar

EQUIPMENT / ACCESSORIES

– Driver included

LOGISTICAL DATA

Product code	Packaging unit (Pieces/Unit)	Dimensions (length x width x height)	Gross weight	Volume
4058075113923	Folding carton box 1	200 mm x 210 mm x 170 mm	1610.00 g	7.14 dm ³
4058075113930	Shipping carton box 4	410 mm x 220 mm x 355 mm	6885.00 g	32.02 dm ³

The mentioned product code describes the smallest quantity unit which can be ordered. One shipping unit can contain one or more single products. When placing an order, for the quantity please enter single or multiples of a shipping unit.

ADDITIONAL CATALOG INFORMATION

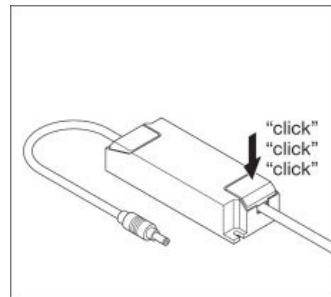
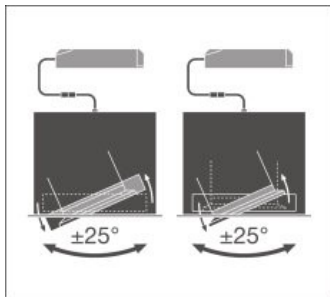

REFERENCES / LINKS

For Guarantee see

▶ www.ledvance.com/guarantee

DISCLAIMER

- Subject to change without notice. Errors and omission excepted. Always make sure to use the most recent release.